

# Aluminium Security Roller Grille

## Roller Grilles

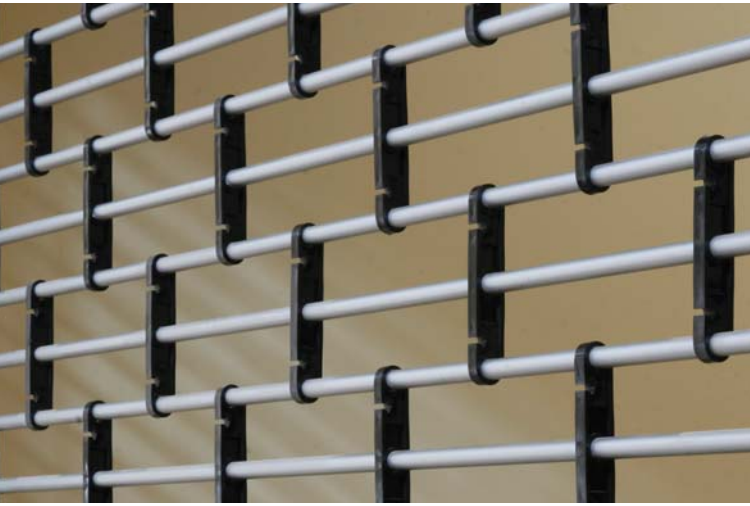

The Aluminium Security Roller Grille provides security and maximum vision and ventilation for internal applications such as shop fronts in shopping centres. It is also suited for entrances, passage ways, bars, counters and partition areas.

### FEATURES

- Light and easy to operate
- Vision
- Ventilation
- Security

### DOOR DIMENSIONS

- Maximum Height: 3000mm\*
- Maximum Width: 3400mm\*

\*Total size must not exceed 10m<sup>2</sup>.

### RECOMMENDED SPECIFICATIONS

Aluminium Security Roller Grille comprising 12mm diameter horizontal aluminium tubes combined with vertical polyethylene links as manufactured by Airport Doors. The Roller Grille operates by means of a flexible grille curtain winding onto an overhead drum and guided in aluminium door guides.

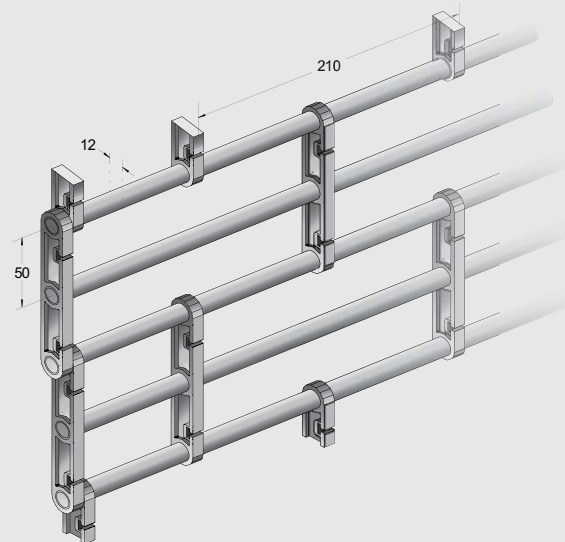

© Copyright 2015 Czapp Pty Ltd trading as Airport Doors. In line with Airport Doors' research and development program, Airport Doors reserves the right to change specifications at any time without notice.

# Aluminium Security Roller Grille

## Roller Grilles

### CURTAIN

The Aluminium Security Roller Grille curtain is manufactured from horizontal 12mm diameter aluminium tubes spaced vertically at 50mm centres and connected with vertical links (made of injection moulded high-density polyethylene) spaced at 210mm centres to form a brick-like pattern.

### FINISH

All aluminium sections are natural anodised as standard and can be colour anodised or powder coated when specified. Polyethylene links are available in selected colours only (typically grey, black or white). Consult manufacturer for current colour availability.

### BOTTOM RAIL

The bottom rail is manufactured from 2.2mm thick by 123mm high specially extruded aluminium section and is fitted with a PVC bottom weather-seal.

### DOOR GUIDES

Aluminium Security Roller Grille standard door guides are manufactured from 2mm thick, 50mm by 30mm extruded aluminium. Where the opening is uneven or not plumb, door guides are used in conjunction with 'take-up' channels (limitations may apply).

### DRUM & SPRING ASSEMBLY

The drum is manufactured from galvanised spiral duct tube revolving around a central steel axle and encasing helical torsion springs matched to suit door size and weight. The drum is attached to nylon drum wheels, which provide bearing support to the shaft, and completely conceal the springs. The drum is designed to provide minimal deflection over the door width.

### DRUM SUPPORT BRACKETS

Aluminium Security Roller Grille drum support brackets are manufactured from either mild steel plate with a thickness of 3mm, or mild steel angle brackets both matched to suit door size and weight. The drum support brackets are prime-coated and are fixed to the wall using masonry anchors or hex head screws, or as specified for steel work.

### FIXING REQUIREMENTS

The building construction (typically timber, steel or core-filled brick) must be structurally sound and have adequate strength to support the Roller Grille and its fixing requirements. Consult manufacturer for further details.

### LOCKING

Hand operated Aluminium Security Roller Grilles will be fitted as standard with a low profile lock which is identically keyed on both sides. The lock will be fitted to the bottom rail as standard and allow full opening height. When specified the lock can be fitted at waist height.

Alternatively, master key locking is also available upon specification. Master key is available as key operated from outside and 'dead' latch on inside. Where required 'free' (hand) latch can be provided on the inside upon specification. Master key can also be provided keyed on the outside and reverse key on the inside when specified.

**NOTE:** Master key locks protrude 14mm-25mm out from the bottom rail, therefore the full opening height cannot be provided (the bottom rail will sit under the lintel in the fully open position).

A shoot-bolt system is also available as an alternative locking option. Padlocks not included.

**NOTE:** Where door is motorised a manual lock, as discussed above, is not fitted.

### MULLIONS (OPTIONAL)

Centre door mullions can be used for wide openings to create multiple door installations. Aluminium Security Roller Grille standard centre mullions, of either removable or fixed type, are manufactured from extruded aluminium of 125mm width.

Removable mullions are designed to give full opening width. A removable centre mullion consists of a lift-out mullion that locks into the bottom plate with locking pins and fits into the mullion head under the lintel. A fixed type mullion is fixed to the floor and lintel.

Corner mullions are used when two roller grilles meet in a corner. The mullion is manufactured from aluminium sheets fabricated to suit the angle and size as required. The width of the angular corner mullions can be minimised if the drums are vertically staged when installed.

### OPERATION

Aluminium Security Roller Grilles operate by means of a flexible grille curtain, winding onto an overhead drum and guided in aluminium door guides. Aluminium Security Roller Grilles can be installed 'behind-fix' or 'between-fix' and are available as hand operated or motorised.

### HAND OPERATION

Hand operation of Aluminium Security Roller Grilles is suitable up to 3000 high by 3000 wide.

### MOTORISATION

Standard motorisation is via a 24v DC motor with a wall push-button that opens and closes the door. The operator plugs into a standard GPO and consists of an emergency manual release mechanism in case of power outage.

Alternatively the Aluminium Security Roller Grille can be motorised using a tubular motor fitted inside the drum. Tubular motors are available in single-phase 240v or 24DC/240v. A manual override mechanism is available to enable manual operation in case of power outage.

Operator selection is dependent on the door size, door weight and the door's application.

The provision of adequate mains power supply and GPO or isolator (as required) to motor location is the responsibility of the client.

Wiring from the isolator and commissioning of the door, motor controllers and any ancillary hardware is by client, unless otherwise stated in writing.

Optional extras, such as access control accessories (e.g. remote control, key switches etc.) and photo electric beams for added safety, are available upon specification. For further information see Door Operators & Accessories.

**NOTE:** Where between-fix is required, tubular motor is used as standard.

### OPTIONS

- Tapered bottom
- Mullions: removable or fixed
- Between-fix installation
- Reverse roll

# Aluminium Security Roller Grille

## Technical Specs: Roller Grilles

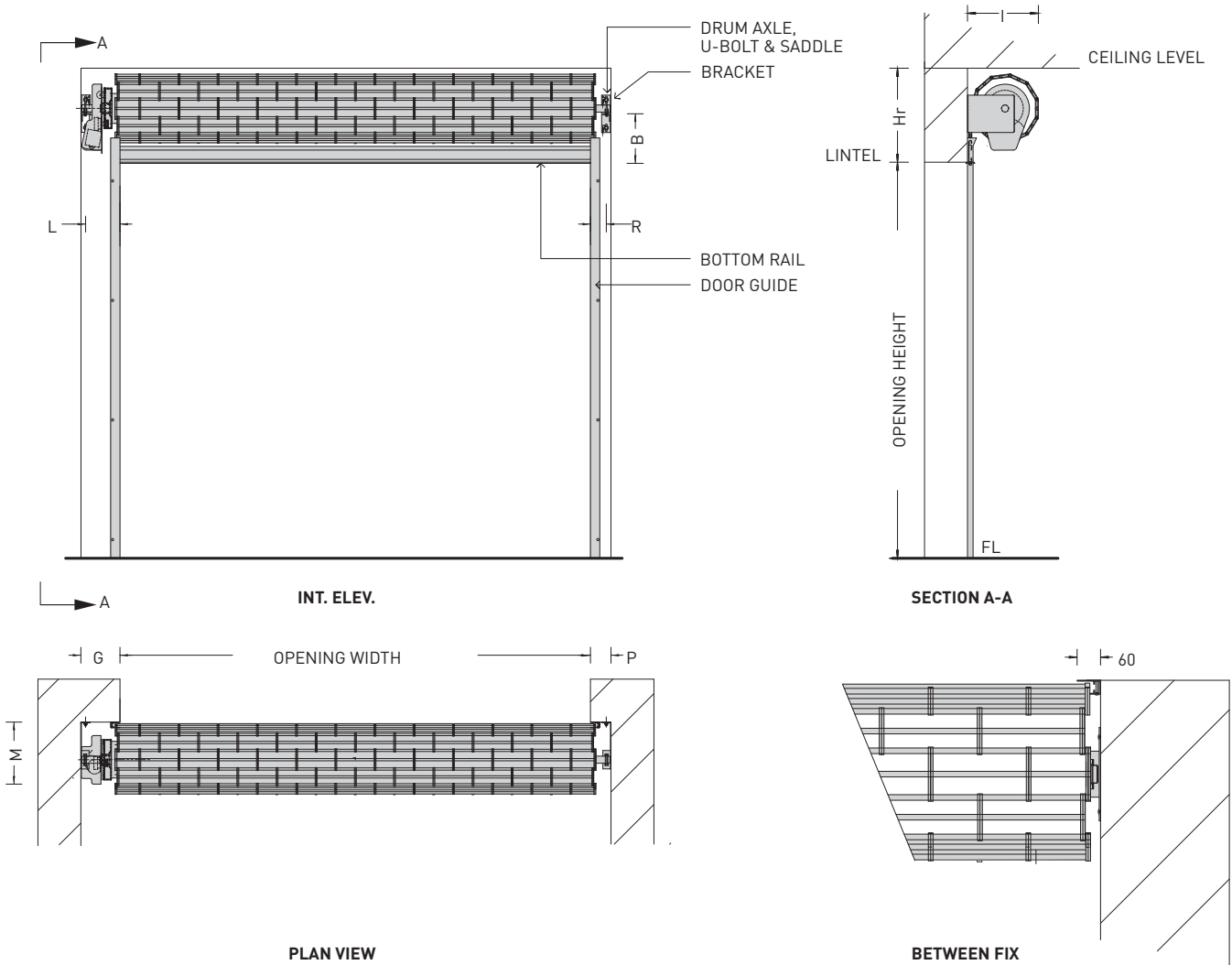

CLEARANCE DETAILS								
HEIGHT UP TO	WIDTH UP TO 3.4m			OPERATION	DRIVEN END		PLAIN END	
	Hr	B	I		G	L	P	R
1100	490	315	300	HAND OPERATION	P	R	100	70
1700	540	340	350	MOTORISATION (STD)	250	190	100	70
2500	580	360	390	MOTORISATION (TUBULAR)	100	80	100	70
3000	580	360	390					

**Notes:**

- \*For 'between-fix' installation, G & P = 0.
- Total door size must not exceed 10m<sup>2</sup>.

# Door Guides

## Technical Specs: Roller Grilles

### STEEL ROLLER GRILLE STANDARD DOOR GUIDE

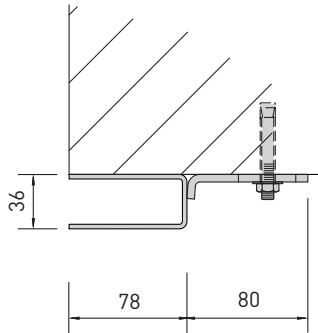

#### STEEL GUIDE

### ALUMINIUM SECURITY ROLLER GRILLE STANDARD DOOR GUIDES

#### BEHIND WALL FIXING

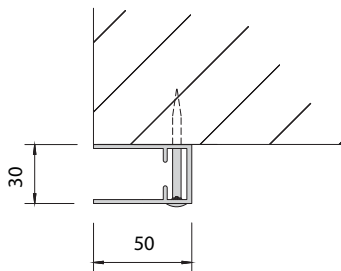

#### ALUMINIUM GUIDE

#### BETWEEN WALL FIXING

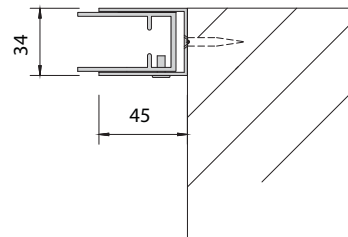

#### ALUMINIUM GUIDE WITH TAKE UP CHANNEL